

# CAST STEEL GLOBE VALVE CLASS 600

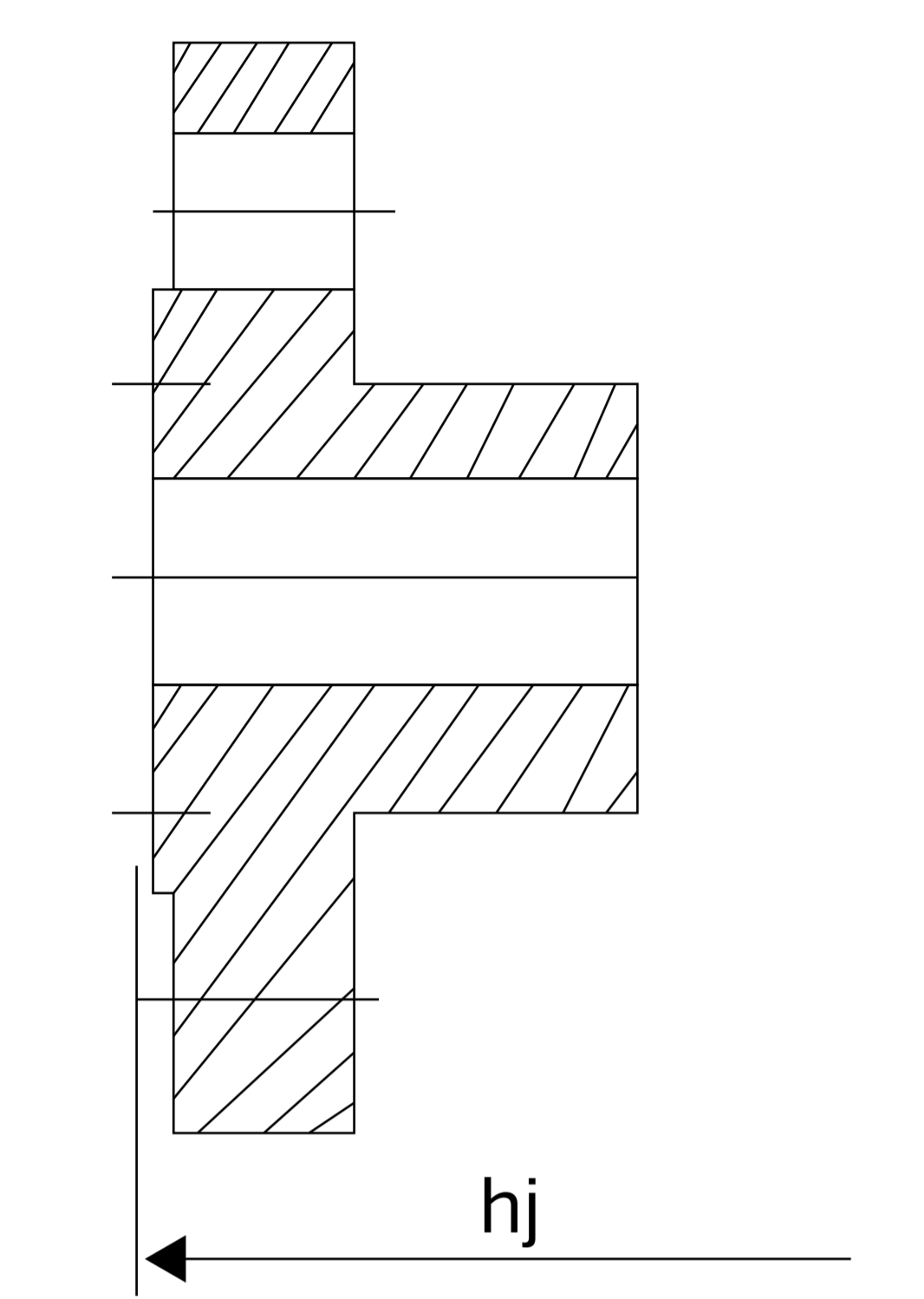

Ring Type Joint End

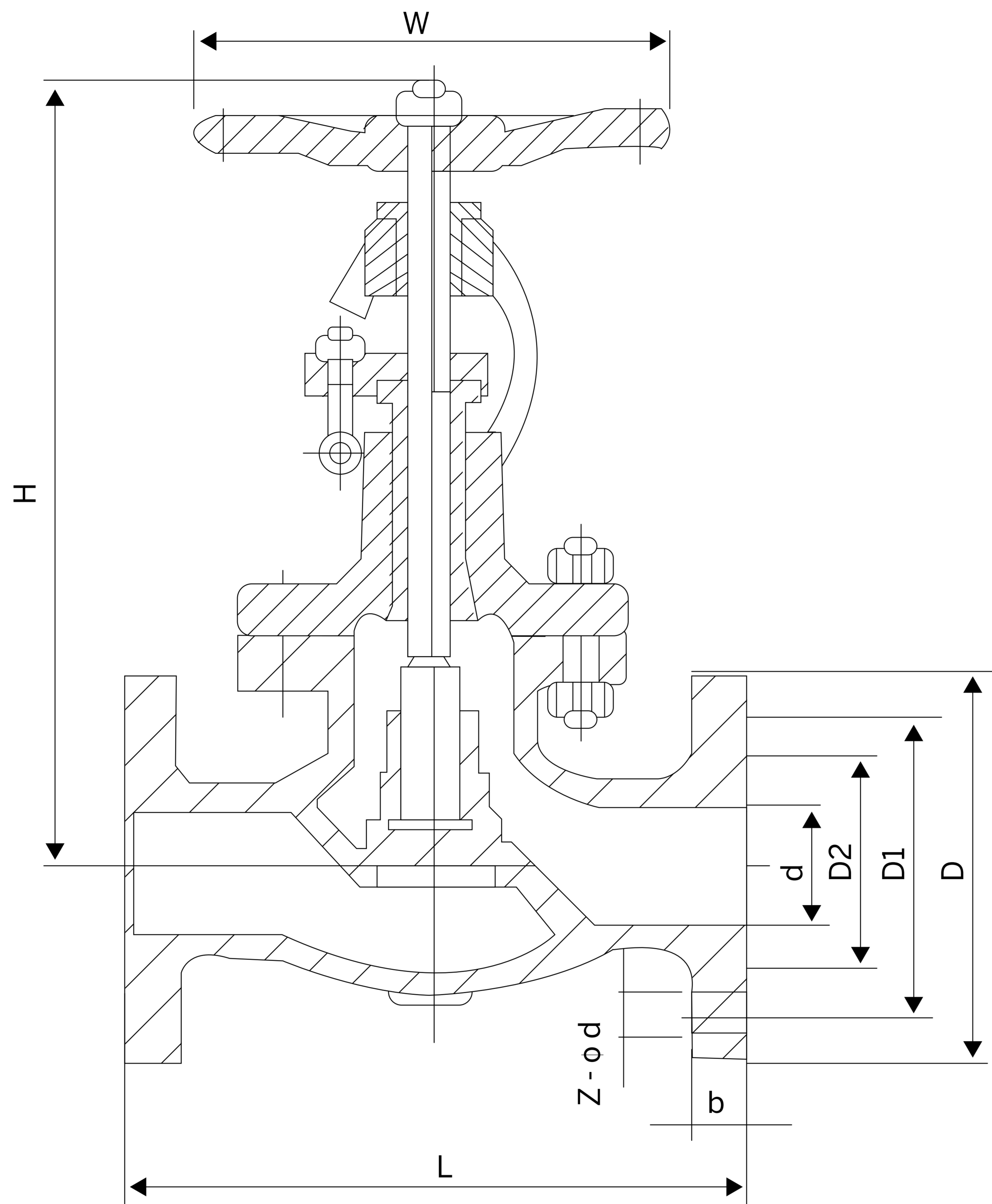
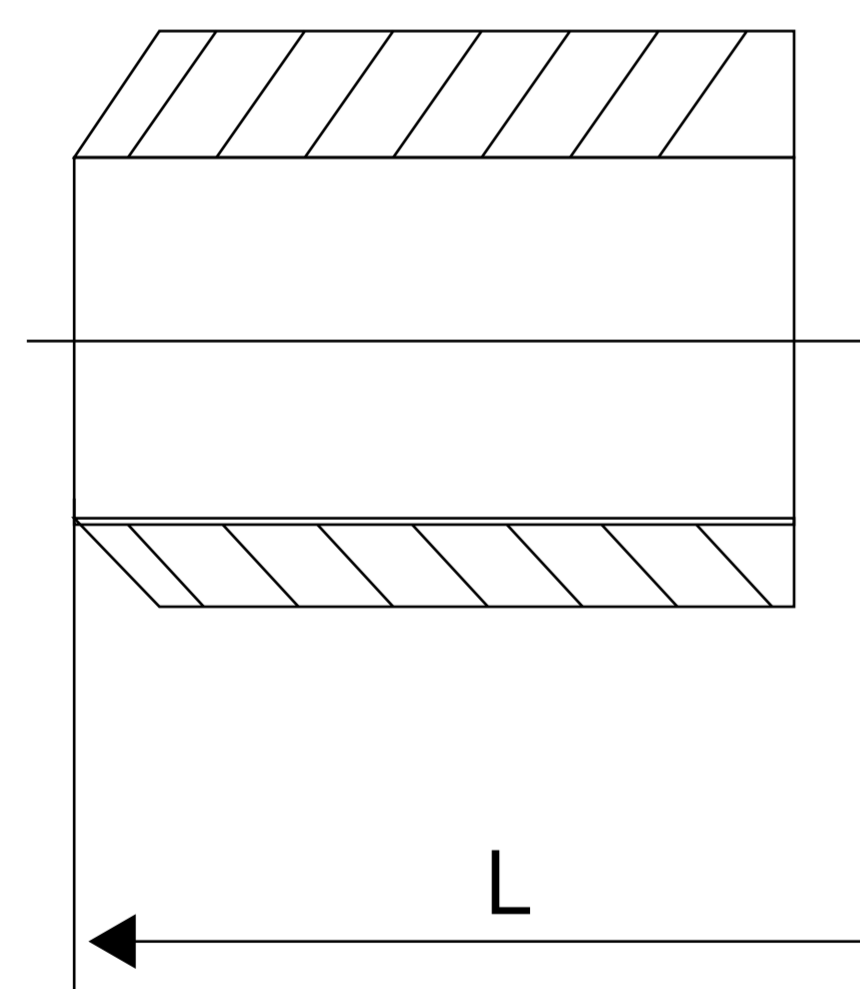

Butt Welding End

### PART MATERIAL

|             |           |      |      |     |      |     |                 |       |     |     |     |
|-------------|-----------|------|------|-----|------|-----|-----------------|-------|-----|-----|-----|
| Shell       | ASTM A216 |      |      |     |      |     | ASTM A351 - CF8 |       |     |     |     |
| Cap         | F6a       |      | F304 |     | F316 |     | Monel           | F304  |     |     |     |
| Seat        | 13Cr      | 13Cr | STL  | 304 | STL  | 316 | STL             | Monel | 304 | 304 | STL |
| Disc Facing | 13Cr      | STL  | STL  | 304 | STL  | 316 | STL             | Monel | 304 | STL | STL |

|             |                 |      |     |                 |     |     |                   |      |     |
|-------------|-----------------|------|-----|-----------------|-----|-----|-------------------|------|-----|
| Shell       | ASTM A351 - CF3 |      |     | ASTM A216 - WCB |     |     | ASTM A 351 - CF3M |      |     |
| Cap         | F304L           |      |     | F316L           |     |     | F316L             |      |     |
| Seat        | 304L            | 304L | STL | 316             | 316 | STL | 316L              | 316L | STL |
| Disc Facing | 304L            | STL  | STL | 316             | STL | STL | 316L              | STL  | STL |

### FEATURES

|   |
|---|
| BB OS & Y Structure                       |
| Flange or Butt-Welding End                |
| Manufacture In Accordance with BS 1873    |
| Flange Dimensions To ANSI B16.5           |
| Butt-Welding End Dimensions To ANSI B16.1 |
| Valve Tested To API 6D or API 598         |

### DIMENSION

| Size   | DN  | d   | L   | Lj  | D   | D1  | D2  | b  | Z-Od  | W   | Open | Wt(Kg) |
|--------|-----|-----|-----|-----|-----|-----|-----|----|-------|-----|------|--------|
| 1/2"   | 15  | 15  | 165 | 164 | 95  | 67  | 35  | 22 | 4-15  | 100 | 162  | 4.5    |
| 3/4"   | 20  | 20  | 190 | 191 | 118 | 83  | 43  | 23 | 4-19  | 140 | 168  | 7.3    |
| 1"     | 25  | 25  | 216 | 216 | 124 | 89  | 51  | 25 | 4-19  | 159 | 194  | 9.6    |
| 1 1/2" | 40  | 40  | 241 | 241 | 156 | 115 | 73  | 30 | 4-22  | 190 | 235  | 19     |
| 2"     | 50  | 50  | 292 | 295 | 165 | 127 | 92  | 33 | 8-19  | 255 | 362  | 35     |
| 2 1/2" | 65  | 65  | 330 | 33  | 190 | 149 | 100 | 36 | 8-22  | 267 | 394  | 50     |
| 3"     | 80  | 80  | 356 | 359 | 210 | 168 | 127 | 39 | 8-22  | 305 | 464  | 60     |
| 4"     | 100 | 100 | 432 | 435 | 273 | 216 | 157 | 45 | 8-25  | 400 | 546  | 110    |
| 6"     | 150 | 150 | 559 | 562 | 356 | 292 | 216 | 55 | 12-29 | 495 | 883  | 230    |

[WWW.VANECO.COM.PE](http://WWW.VANECO.COM.PE)

Email: [ventas@vaneco.com.pe](mailto:ventas@vaneco.com.pe)

Oficina: Av. Andrés Razuri 207 Urb. Maranga San Miguel

Almacén Principal: Avenida Nicolas Ayllón 2635 – Interior C3

Central telefónica: (511) 5170130  948544608